



Sonic Facial Cleanser
Professional Dermal Cleansing

Instruction Manual



SSPA01

sensio Spa



sensio Spa

Thank you for purchasing the Sonic Facial Cleanser.

The Sonic Facial Cleanser is a splashproof unit which is ideal for use in the bathroom. It operates with three exchangeable attachments; A brush head for normal skin, a brush head for sensitive skin and a dermabrasion brush head. It features two speeds; low for regular cleaning and high for deep cleaning and exfoliation.

Key Features

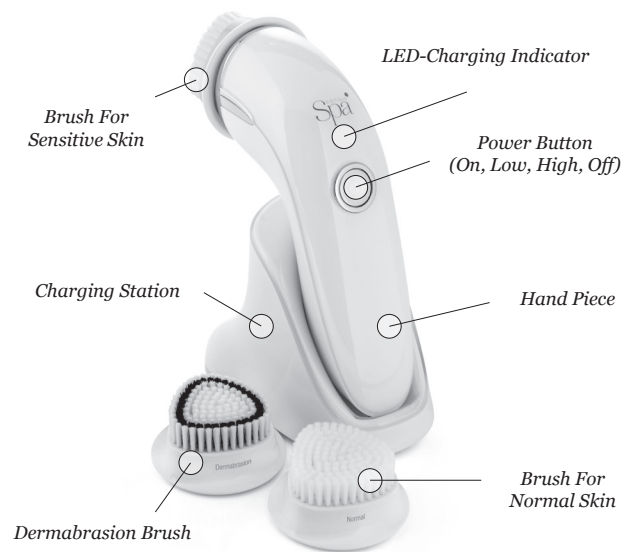

Preparations before use

1. Insert the small plug of the charging adaptor into the base of the charging station.
2. Plug the charging adaptor into the wall socket outlet and switch on. For safety purposes, make sure the outlet features a circuit breaker.
3. Place the hand piece into the charging station base. The LED-charging indicator will flash. Allow up to 3 hours for full charge before using or when the LED-charging indicator stops flashing. Note: Unit will beep every 30 seconds when it needs to be recharged. Average usage time on low speed is 90 minutes and 60 minutes on high speed.
4. Select the required brush and connect to the hand piece.

The Sonic Facial Cleanser is equipped with a built-in timer that beeps to tell you to move from one part of the face to another. The timer is programmed to treat:

- Forehead - 20 seconds
- Nose and chin - 20 seconds
- Cheeks - 2 x 10 seconds for each cheek
- Neck and neckline - 20 seconds

The appliance will shut off automatically after the cycle is completed. You can power off the appliance anytime using the power button on the hand piece.

The Sonic Facial Cleanser features two speeds to adjust the intensity of the vibration.

- Low Speed: This speed is automatically activated when the appliance is turned on. The LED illuminates with a constant dim glow.
- High Speed: This speed becomes active after you press the power button again after turning it on. The LED illuminates with a constant intense glow.

The Sonic Facial Cleanser is now ready for use.

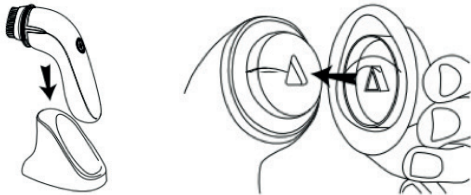

Directions For Use Cleansing

- The normal and sensitive brushes are recommended for daily cleansing use.
- Remove makeup as normal. Do not use the Sonic Facial Cleanser to remove eye makeup. If you use the Sonic Facial Cleanser to remove face makeup, make sure to clean the brush afterwards as makeup can stain the brush.
- Apply the cleansing brush of choice to the hand piece (normal or sensitive).
- Dampen the face, neck and neckline.
- Dampen the brush head and apply the cleansing product of your choice to the desired areas.
- Switch the Sonic Facial Cleanser on using the power button. Press once for low vibration and press twice for high vibration.
- Cycle will start immediately.
- Slide the brush over different areas as described using gentle circular movements. Do not press unit into skin. Do not use around the sensitive skin area around the eyes.
- Turn the Sonic Facial Cleanser off, rinse off the brush head and return the appliance to the charging station. Rinse the face and neck area with water.

Exfoliation

- The dermabrasion brush is recommended for use once a week for exfoliation.
- Remove makeup as normal. Do not use the Sonic Facial Cleanser to remove eye makeup.
- Apply the dermabrasion brush to the hand piece.
- Dampen the face, neck and neckline.
- Dampen the brush head and apply the cleansing or exfoliation product of your choice to the desired areas.

- Switch the Sonic Facial Cleanser on using the power button. Press once for low vibration and press twice for high vibration.
- Cycle will start immediately.
- Slide the brush over different areas as described using gentle circular movements. Do not use around the sensitive skin area around the eyes.
- Turn the Sonic Facial Cleanser off, rinse off the brush head and return the appliance to the charging station. Rinse the face and neck area with water.

Cleaning and Maintenance

Clean the appliance and all brushes each time after use. Do not use any alcohol, acetone, abrasive cleaners, etc. to clean the housing of the appliance.

- Rinse brushes with tap water. Max water temperature should not exceed 50°C. Make sure to rinse the bristles on brushes. Clean the hand piece as needed with mild detergent.
- Use a damp cloth to clean any residue remaining on the hand piece.
- Dry with a clean towel.
- When dry, replace the protective covers on the brushes.
- Store the hand piece in the charging station. **IMPORTANT:** If the unit is not to be used for a long time, unplug the charging station and store in dry, cool place.
- Do not place any parts in a dishwasher for cleaning.
- Replace the brushes every 2-3 months for optimum cleansing and exfoliation results.
- Replace the brush if the deformed bristles can no longer be restored to their original shape. Worn bristles will move impurities around rather than remove them, as well as irritate your skin.
- For spare brushes, please contact Customer Services quoting the appliance number for up-to-date prices and availability.

Important Cautions and Warnings

Please read all instructions before use and pay particular attention to any warnings.

- If you have any concerns regarding your health, consult a doctor before using this appliance. Individuals with pacemakers and pregnant women should consult a doctor before using this appliance.
- This appliance can be used by children aged from 8 years and above and by persons with reduced physical, sensory or mental capabilities or lack of experience and knowledge if they have been given supervision or instruction concerning use of the appliance in a safe way and if they understand the hazards involved. Children shall not play with the appliance. Cleaning and user maintenance shall not be made by children without supervision.
- This appliance is **NOT** a toy. Keep the appliance out of the reach of children younger than 12 years.
- This appliance should **NEVER** be used by any individual suffering from any physical ailment that would limit the user's capacity to operate the controls or who has sensory deficiencies in the lower half of their body.
- **NEVER** use directly on chapped, swollen or inflamed areas, or if suffering from skin diseases, irritations or if taking steroid based medication.
- This is a non-professional appliance, designed for personal use and intended to provide a soothing massage to work muscles. **DO NOT** substitute for medical attention.
- **DO NOT** use for longer than the recommended time of 1 minute, 20 seconds.
- This product contains small parts that may present a choking hazard for young children.
- Sonic Facial Cleanser can be used in the shower. However, do not use in bathtub or immerse in water.
- **DO NOT** use the Sonic Facial Cleanser hand piece when charging.
- **DO NOT** use after chemical peeling or microdermabrasion.

- **DO NOT** share the appliance, especially the brush heads, with others for hygiene reasons.
- If irritation occurs during use, switch to the sensitive brush head.
- Only use the appliance with the supplied charging adaptor. If damaged, only replace it with one of the original type to avoid an electrical hazard.
- Do not use the appliance, attachments or the adaptor if it is damaged or broken to avoid injuries.

Keep these instructions safe for future reference.

Warranty

This product is guaranteed for a period of 2 years from the date of purchase, against mechanical and electrical defects, when registered at www.sensiospa.com within 28 days of purchase. NB: Non-registered products are guaranteed for a period of 1 year.

It is particularly important that you carefully read the instructions provided, in order to get maximum use from this product.

This guarantee is only valid if the appliance is used solely for domestic purposes in accordance with the instructions and provided that it is not connected to an unsuitable electricity supply, dismantled or interfered with in any way or damaged through misuse. Under this guarantee we undertake to repair or replace free of charge any parts found to be defective.

This guarantee is only valid with your original sales receipt as proof of purchase. You may wish to attach the receipt to this card for ease of reference and to avoid accidental loss.

In the unlikely event of a fault or mechanical defect in material and workmanship within the 12 months of purchase the product should be returned to the retailer for replacement.

If the fault develops after 12 months and within 24 months from the date of original purchase and you have registered your product online within 28 days of purchase, you should contact customer services quoting the products model number and batch code.

This information can be located on the underside or back of the product. The batch code will be stated in an YYWW format (e.g. 1133).

For spare parts please contact customer services quoting the product's model number and batch code. They will give you up-to-date prices.

Warranty Exclusions

1. Batteries and damage from leakage is not covered by the terms of the guarantee.
2. The warranty does not cover acts of God such as fire, floods, hurricanes or tornadoes or use for rental or commercial services.
3. Consumable items such as brushes are not covered under this warranty.

This guarantee does not cover any claims for consequential loss or damage.

This guarantee is only valid within the UK and Ireland. Nothing in this guarantee or the instructions relating to this product excludes, restricts or otherwise affects your statutory rights.

In line with our policy of continuous product development we reserve the right to change the product, packaging and documentation specifications without notice.

ALL MPL HOME PRODUCTS ARE INTENDED FOR DOMESTIC USE ONLY

For technical queries, please contact
MPL Home Ltd IMEX, 575 - 599 Maxted Road, Hemel Hempstead, Herts, HP2 7DX
Model: **SSPA01**
Customer Helpline: **0345 467 6743**

IMPORTANT INFORMATION FOR CORRECT DISPOSAL OF THE PRODUCT IN
ACCORDANCE WITH EC DIRECTIVE 2002/96/EC

At the end of its working life, the product must not be disposed of as urban waste. It must be taken to a special local authority differentiated waste collection centre or to a dealer providing this service. Disposing of a household appliance separately avoids possible negative consequences for the environment and health, deriving from inappropriate disposal and enables the constituent materials to be recovered to obtain significant savings in energy and resources. As a reminder of the need to dispose of household appliance separately, the product is marked with crossed-out wheeled dustbin.



Sensio Spa



sensio
Spa

www.sensiospa.com